



pearson  
ferrier  *a property for everyone*

142 CHESHAM ROAD  
Bury, BL9 6EL  
Offers Over £150,000

# 142 CHESHAM ROAD

## Property at a glance

- GARDEN FRONTED PERIOD TERRACED
- FABULOUS POSITION OVERLOOKING PARKLAND
- CONVENIENT TO TOWN CENTRE
- TWO DOUBLE BEDROOMS (MAIN FITTED)
- RECENTLY INSTALLED KITCHEN & BATHROOM
- TWO RECEPTION ROOMS
- COMBINATION GAS CENTRAL HEATING
- UPVC DOUBLE GLAZING
- GARAGE TO REAR

A traditional Edwardian garden fronted mid terraced property with outstanding views to the front over Walkers Fields and yet only a short distance from a handy parade of shops and just over half a mile from Bury town centre. The current owners have just completed a good deal of restoration work over the last couple of years and have cleverly blended modern convenience with features of the Edwardian era. The property has combination gas central heating, upvc double glazing, a redesigned and replacement kitchen by locally renowned Ramsbottom Kitchens with a range of Neff appliances, replacement four piece bathroom with separate shower and in the lounge a log burner has been fitted. The accommodation briefly comprises: entrance vestibule, inner hall, lounge, dining/sitting room with opening onto the eat-in kitchen, first floor landing, two double bedrooms (the main with fitted wardrobes) and newly installed four piece bathroom. To the outside there are low maintenance gardens to the front and a newly laid (March 2021) rear patio with shingle areas and timber decking leading to the single garage with up and over door. The garage was re roofed again in 2021.





GROUND FLOOR  
48.6 sq.m. (524 sq.ft.) approx.

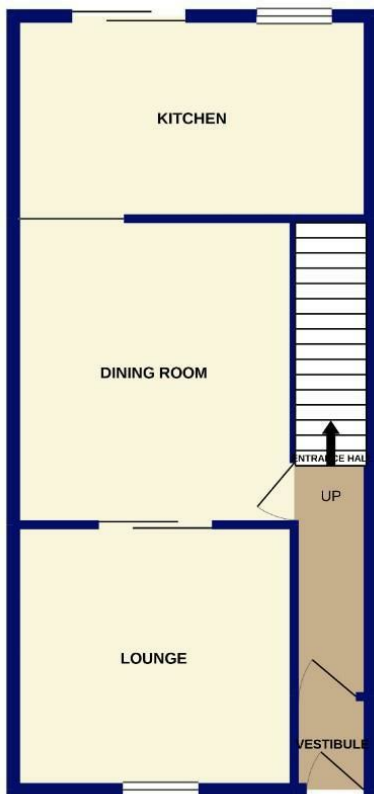

1ST FLOOR  
40.5 sq.m. (436 sq.ft.) approx.



TOTAL FLOOR AREA: 89.2 sq.m. (960 sq.ft.) approx.

Whilst every attempt has been made to ensure the accuracy of the floorplan contained here, measurements of doors, windows, rooms and any other items are approximate and no responsibility is taken for any error, omission or mis-statement. This plan is for illustrative purposes only and should be used as such by any prospective purchaser. The services, systems and appliances shown have not been tested and no guarantee as to their operability or efficiency can be given.  
Made with Metropix 10/2021

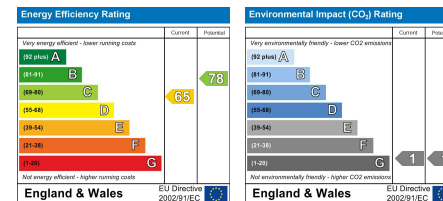

Bury Office  
435/7 Walmersley Road, Bury, Lancashire, BL9 5EU  
Telephone: 0161 764 4440  
Fax: #  
Email: bury@pearsonferrier.co.uk

www.pearsonferrier.co.uk

pearson  
ferrier

a property for everyone